

Habitat Aura

Luxury Homes off Bannerghatta Road

YOUR HAPPINESS HAS
A PERMANENT ADDRESS



Fund Partner



PRM/KA/RERA/1251/310/PR/181219/002235



**BENGALURU'S VERY OWN INTERNATIONAL AWARD WINNING ARCHITECT DEVELOPER
14 YEARS, 2.5 MILLION SFT. DELIVERED ACROSS 15 PROJECTS**

ABOUT HABITAT

Habitat Ventures builds world class living spaces for people with a zest for life. A deep understanding of market needs and individual aspirations combined with a breadth of technical knowledge has endowed the Group with the expertise to deliver exactly what the client wants, consistently outdoing industry benchmarks.



AWARDS

- 🏆 'BEST ARCHITECTURAL DESIGN PROJECT OF THE YEAR - 2016' by Siliconindia Real Estate Awards 2016.
- 🏆 'DEVELOPMENT MARKETING, INDIA' by Asia Pacific Property Award 2014 – 2015.
- 🏆 'BEST DEVELOPER WEBSITE - habitatventures.com' by Asia Pacific Property Award 2014 – 2015.
- 🏆 'BEST RESIDENTIAL ARCHITECTURE, KARNATAKA' by Worldwide Achievers Real Estate Awards 2014.
- 🏆 'DEVELOPMENT MULTIPLE UNITS, INDIA' by Asia Pacific Property Award 2013 – 2014.
- 🏆 'BEST RESIDENTIAL PROJECT IN LUXURY SEGMENT, BENGALURU' by CNBC Awaaz & RR Kabel 2013.
- 🏆 'LUXURY PROJECT OF THE YEAR, EAST BANGALORE' by Siliconindia & Axis Bank, 2013.
- 🏆 'EMERGING DEVELOPER OF THE YEAR 2012' by Siliconindia & LIC HFL.

A Bird's Eye View





3 BHK SMART A

Saleable SBUA - 1455 Sqft
RERA Carpet Area - 976 Sqft
Private Balcony - 65.76 Sqft

- 1 LIVING / DINING**
7925 X 3350 (26'0" X 11'0")
- 2 M- BED ROOM**
3200 X 4270 (10'6" X 14'0")
- 3 A- TOILET**
1525 X 2450 (5'0" X 8'0")
- 4 TOILET -2**
1525 X 2450 (5'0" X 8'0")
- 5 BED ROOM-2**
3050 X 4270 (10'0" X 14'0")
- 6 BALCONY**
1825 X 3350 (6'0" X 11'0")
- 7 BED ROOM-3**
3050 X 2450 (10'0" X 8'0")
- 8 POWDER ROOM**
1525 X 1675 (5'0" X 5'6")
- 9 UTILITY**
1525 X 2450 (5'0" X 8'0")
- 10 KITCHEN**
3200 X 2450 (10'6" X 8'0")





3 BHK SMART B

Saleable SBUA - 1486 Sqft
RERA Carpet Area - 976 Sqft
Private Balcony - 87.40 Sqft

- 1 LIVING / DINING**
7925 X 3350 (26'0" X 11'0")
- 2 M- BED ROOM**
3200 X 4270 (10'6" X 14'0")
- 3 A- TOILET**
1525 X 2450 (5'0" X 8'0")
- 4 TOILET -2**
1525 X 2450 (5'0" X 8'0")
- 5 BED ROOM-2**
3050 X 4270 (10'0" X 14'0")
- 6 BALCONY**
2425 X 3350 (7'11" X 11'0")
- 7 BED ROOM-3**
3050 X 2450 (10'0" X 8'0")
- 8 POWDER ROOM**
1525 X 1675 (5'0" X 5'6")
- 9 UTILITY**
1525 X 2450 (5'0" X 8'0")
- 10 KITCHEN**
3200 X 2450 (10'6" X 8'0")





3 BHK LUXURY A

Saleable SBUA - 1653 Sqft
RERA Carpet Area - 1075 Sqft
Private Balcony - 110.86 Sqft

- 1 LIVING / DINING**
8150 X 3650 (26'9" X 12'0")
- 2 BED ROOM-3**
3200 X 3650 (10'6" X 12'0")
- 3 UTILITY BALCONY**
2900 X 1000 (9'6" X 3'3")
- 4 TOILET -3**
1525 X 2450 (5'0" X 8'0")
- 5 TOILET -2**
1525 X 2450 (5'0" X 8'0")
- 6 BED ROOM-2**
3845 X 3650 (12'7" X 12'0")
- 7 BALCONY**
1850 X 3650 (6'1" X 12'0")
- 8 M- BED ROOM**
4345 X 3200 (14'3" X 10'6")
- 9 A- TOILET**
1825 X 2100 (6'0" X 6'11")
- 10 KITCHEN/UTILITY**
4125 X 3200 (13'6" X 10'6")





3 BHK LUXURY B

Saleable SBUA - 1713 Sqft
RERA Carpet Area - 1075 Sqft
Private Balcony - 154.00 Sqft

- 1 LIVING / DINING
8150 X 3650 (26'9" X 12'0")
- 2 BED ROOM - 1
3200 X 3650 (10'6" X 12'0")
- 3 UTILITY BALCONY
2900 X 1000 (9'6" X 3'3")
- 4 TOILET - 1
1525 X 2450 (5'0" X 8'0")
- 5 TOILET - 2
1525 X 2450 (5'0" X 8'0")
- 6 BED ROOM - 2
3845 X 3650 (12'7" X 12'0")
- 7 BALCONY
2945 X 3650 (9'8" X 12'0")
- 8 M- BED ROOM
4345 X 3200 (14'3" X 10'6")
- 9 A- TOILET
1825 X 2100 (6'0" X 6'11")
- 10 KITCHEN/UTILITY
4125 X 3200 (13'6" X 10'6")



LIVE, PLAY AND UNWIND

CLUB HOUSE AMENITIES

- INFINITY SWIMMING POOL
- GYM
- YOGA/AEROBICS ROOM
- TABLE TENNIS AREA
- POOL TABLE
- MULTIPURPOSE HALL
- SPACE FOR READING ROOM / ASSOCIATION ROOM
- SPACE FOR ADMIN OFFICE
- GUEST ROOMS
- LOUNGE\ LOBBY
- PUBLIC TOILET - SEPERATE GENTS / LADIES TOILETS
- DEDICATED LIFT FOR CLUB HOUSE



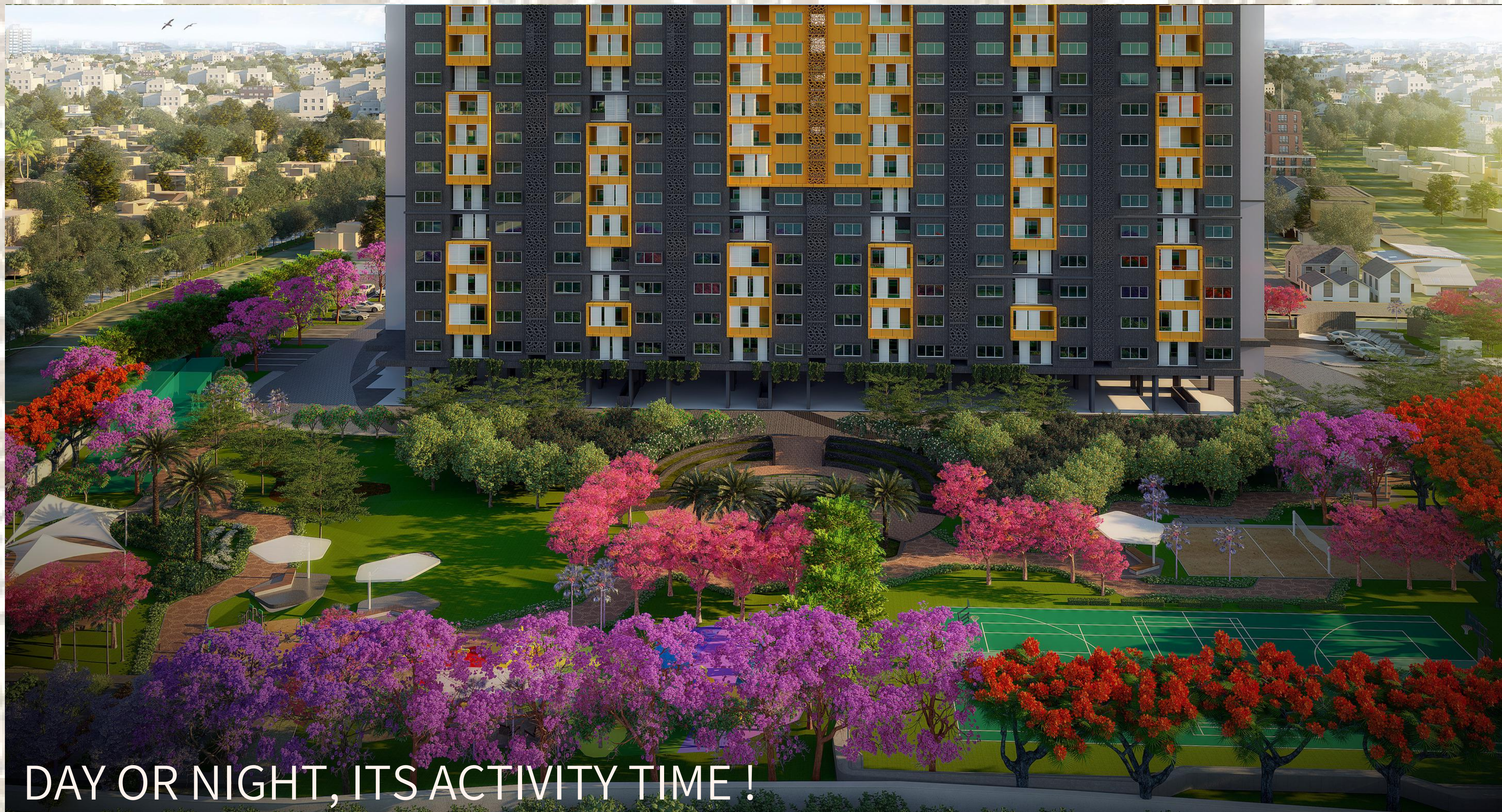

DAY OR NIGHT, ITS ACTIVITY TIME!

- JOGGING TRACKS/ WALKWAYS AMIDST LANDSCAPED AREAS.
- CHILDREN'S PLAY AREA.
- HERBAL GARDEN.

- CRICKET NET PRACTICE PITCH.
- ELDER'S / SENIOR CITIZEN'S PARK.

- MULTI-COURT FOR
- TENNIS
 - BASKETBALL
 - VOLLEYBALL
 - BADMINTON

LANDSCAPED GARDENS

- INFORMAL SEATING & RELAXATION SPACES AMIDST LANDSCAPED AREAS.

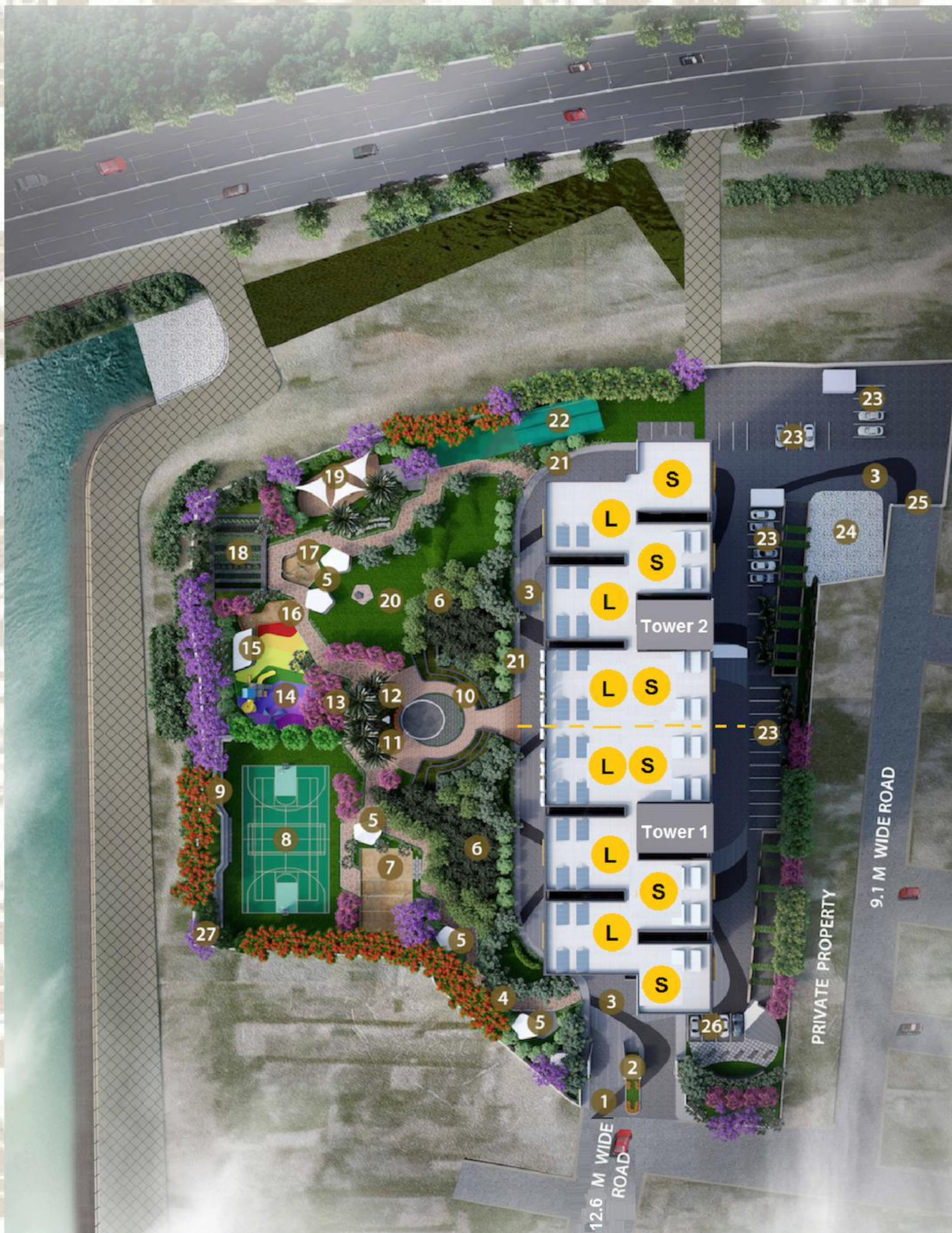

Master Plan

- 1 Approach Driveway
- 2 Security Guard House
- 3 Fire Tender Driveway
- 4 Meandering Jogging Trail
- 5 Seating Alcove W/Canopy
- 6 Fruit Orchard/ Mini Forest
- 7 Beach Volley Ball Court
- 8 Multi-Purpose Court
- 9 Gallery Seating
- 10 Amphitheater
- 11 Sculpture Court
- 12 Feature Sculpture
- 13 Palm Grove
- 14 Children's Play Area
- 15 Care Taker's Pavilion
- 16 (Tot-Lot) Sand Pit
- 17 Outdoor Exercise Station
- 18 Organic Garden
- 19 Yoga Cum Meditation Deck
- 20 Party Lawn W/ Bonfire Pit
- 21 Pedestrian Pathway
- 22 Cricket Practice Net
- 23 Car Parking
- 24 Services Yard
- 25 Secondary Approach
- 26 Visitor's Car Parking



Location Map

Site Address
Off Bannerghatta Road ,
Arekere Village ,
Begur Hobli
Bangalore - 76

Search
Habitat Aura
in Google Maps

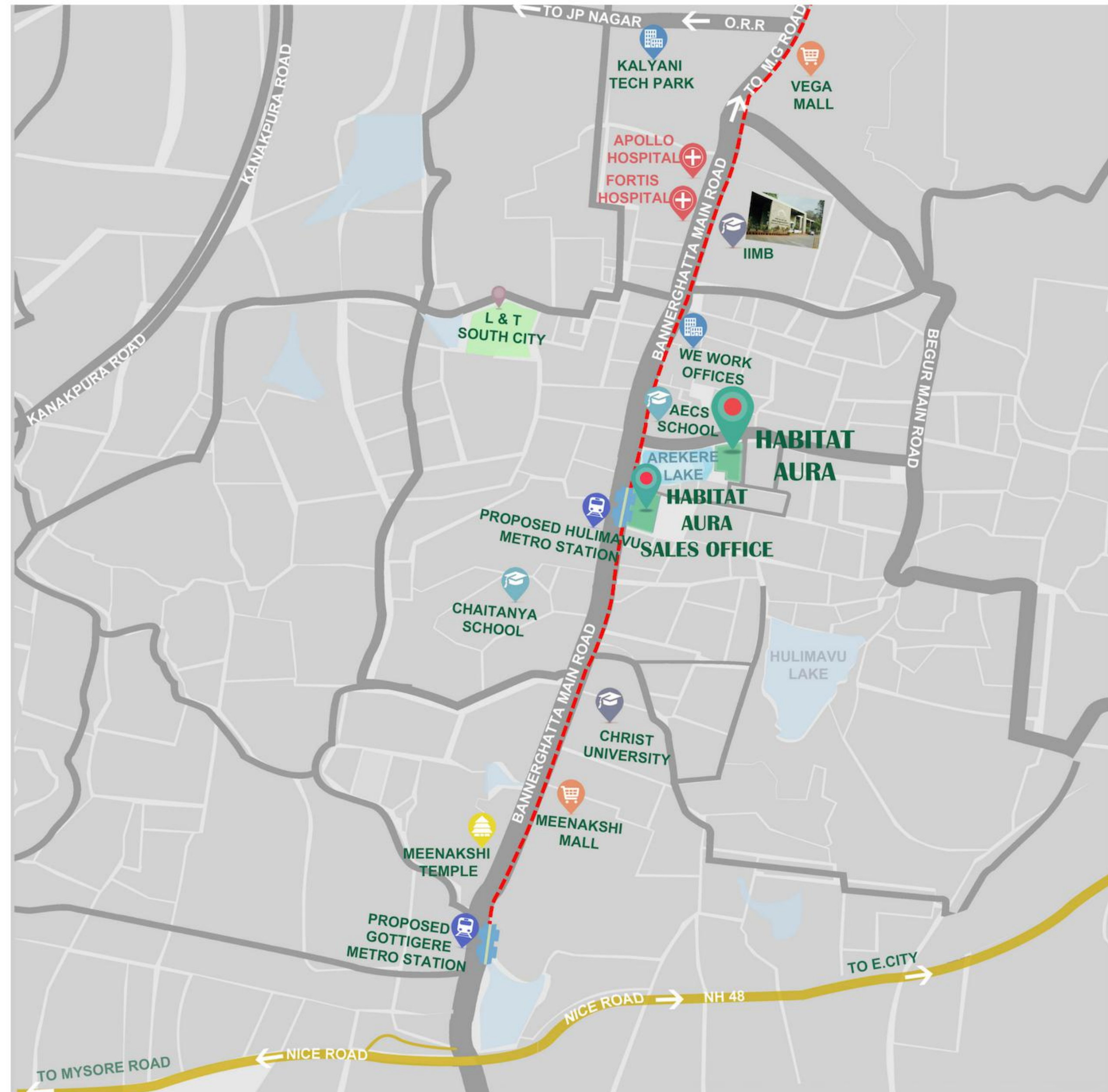

Our Other Ongoing Projects



FROM Rs. 48 LACS*

Habitat Iuminar
2, 2.5 & 3 BHK Lifestyle Homes
Near RVCE, Off Mysore Road

PRM/KA/RERA/1251/310/PR/170915/000183

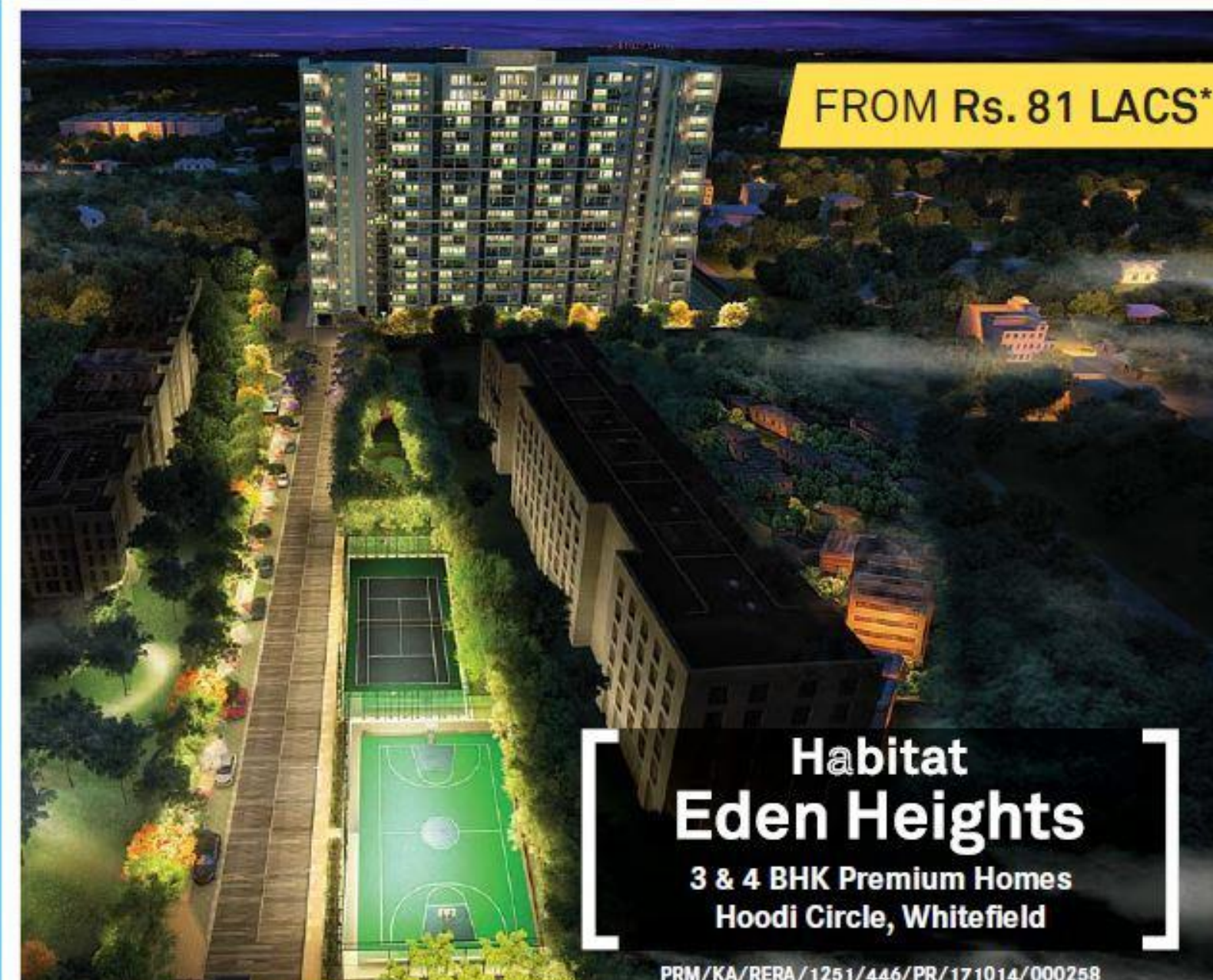

FROM Rs. 81 LACS*

Habitat Eden Heights
3 & 4 BHK Premium Homes
Hoodi Circle, Whitefield

PRM/KA/RERA/1251/446/PR/171014/000258



+91 8088 663 663 | aura@habitatventures.com | www.habitatventures.com



CORPORATE OFFICE: #26, HABITAT VENTURES, SHANKARMUTT ROAD, BASAVANGUDI, BANGALORE -560004. TEL: 080 – 41469220/21, E: info@habitatventures.com

SITE OFFICE: OFF BANNERGHATTA MAIN ROAD, ARAKERE VILLAGE, BEGUR HOBLI, BENGALURU SOUTH TALUK - 560076

This leaflet is purely conceptual and project is under pre-launch stage and subject to change without prior notice. The intended areas mentioned is subjected to change as per final approved drawings. 1 sqm. = 10.763 sft. Q1, 2017.